

# MULTIBECK

## USING WITH BROILERS

### BEFORE CHICKS ARRIVE

- ▶ Turn the upper pan  $\frac{3}{4}$  to 1 turn from lower pan

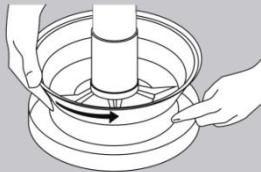

- ▶ Turn on the feed line
- ▶ Distribute the feed by slightly shaking the feeder

**BROILER'S BACK → LEVEL WITH LOWER PAN EDGE**  
(The neck of the bird should be slightly outstretched when eating)

